



PREMIUM-WERKZEUGE



PREMIUM TOOLS



ALLEN KEY SETS



151.3250

HEXAGON KEY WRENCH SET ON A RING

- In accordance to DIN ISO 2936
- Storage ring
- Continuous hardened
- Phosphate finish
- Special tool steel



2 - 2,5 - 3 - 4 - 5 - 6 - 8 - 10 mm

8
pcs

SOCKET ALLEN KEY SET, SHORT

- Short execution
- DIN ISO 2936
- Continuous hardened
- Matt chrome
- Special tool steel
- In durable folding holder

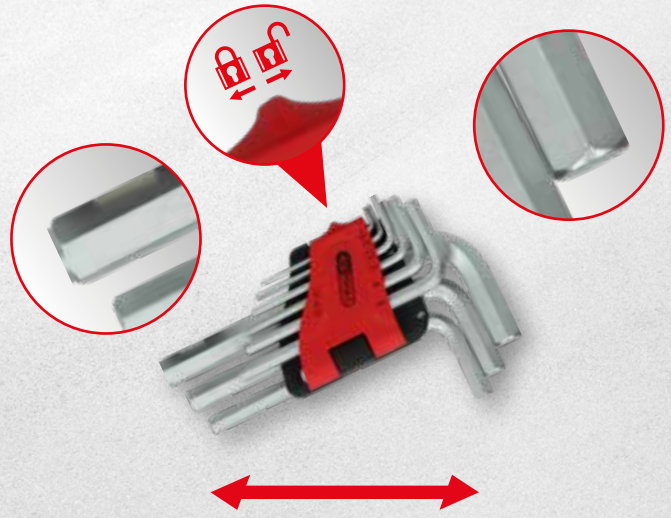

Short



151.3212	9 pcs	1,5 - 2 - 2,5 - 3 - 4 - 5 - 6 - 8 - 10 mm	€ 9, ⁹⁰
151.5080	10 pcs	1,5 - 2 - 2,5 - 3 - 4 - 5 - 6 - 7 - 8 - 10 mm	€ 11, ⁹⁰
151.4590	14 pcs	1,5 - 2 - 2,5 - 3 - 4 - 5 - 6 - 7 - 8 - 10 - 12 - 14 - 17 - 19 mm	€ 27, ⁹⁰

6,50 €

158.3540

HEXAGON KEY WRENCH SET

- In accordance to DIN ISO 2936
- Continuous hardened
- Matt chrome
- Special tool steel
- In a durable folding holder with two component housing



2,5 - 3 - 4 - 5 - 6 - 7 - 8 - 10 mm

8
pcs

SOCKET ALLEN KEY SET, SHORT

- Short execution
- DIN ISO 2936
- Imperial sizes
- Continuous hardened
- Matt chrome
- Special tool steel
- In durable folding holder

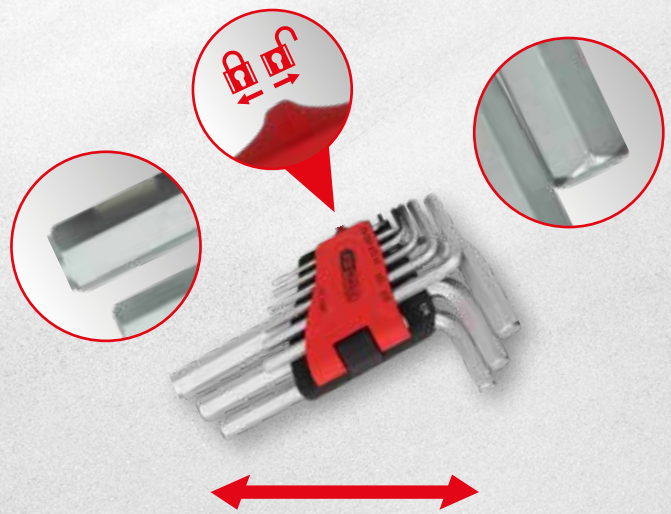

Short



151.4540	9 pcs	1/16" - 5/64" - 3/32" - 1/8" - 5/32" - 3/16" - 1/4" - 5/16" - 3/8"	€ 9, ⁹⁰
151.5060	10 pcs	1/16" - 5/64" - 3/32" - 1/8" - 5/32" - 3/16" - 7/32" - 1/4" - 5/16" - 3/8"	€ 11, ⁹⁰
151.4600	14 pcs	1/16" - 5/64" - 3/32" - 1/8" - 5/32" - 3/16" - 7/32" - 1/4" - 5/16" - 3/8" - 1/2" - 9/16" - 5/8" - 3/4"	€ 27, ⁹⁰

16,50 €

*This is an limited special price offer - only until stocks last.

All prices are ex. VAT. With the release of this leaflet all previous prices became invalid. Sold only in specialist stores. Print mistakes, errors and technical alterations excepted. Prices valid up to 30.09.2023



ALLEN KEY SETS

151.5040

ALLEN KEY SET, LONG

- Long execution
- DIN ISO 2936
- Continuous hardened
- Matt chrome
- Special tool steel
- In durable folding holder

10
pcs

151.4980

ALLEN KEY SET, EXTRA LONG

- Extra long execution
- DIN ISO 2936
- Continuous hardened
- Matt chrome
- Special tool steel
- In durable folding holder

10
pcs

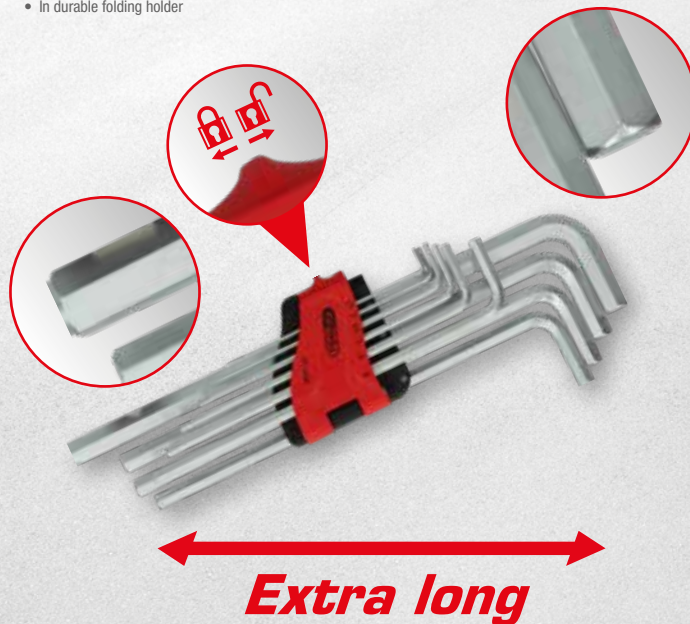
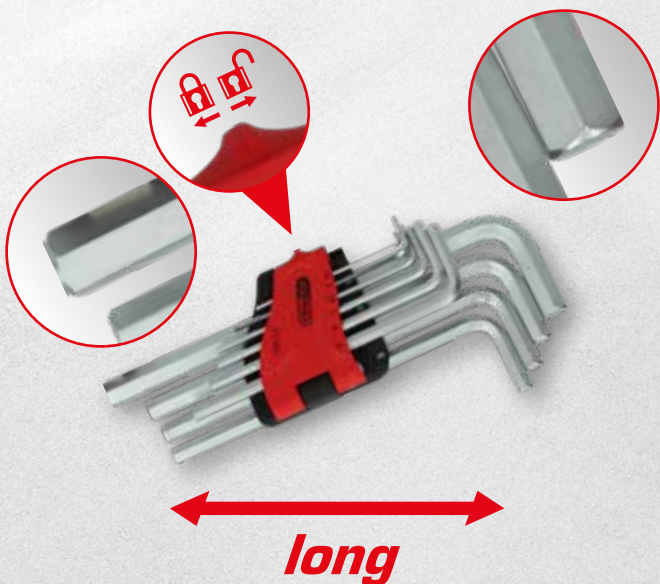

1,5 - 2 - 2,5 - 3 - 4 - 5 - 6 - 7 - 8 - 10 mm



1,5 - 2 - 2,5 - 3 - 4 - 5 - 6 - 7 - 8 - 10 mm

21,50 €

27,90 €

151.5020

ALLEN KEY SET, LONG

- Long execution
- DIN ISO 2936
- Imperial sizes
- Continuous hardened
- Matt chrome
- Special tool steel
- In durable folding holder

10
pcs

151.4960

ALLEN KEY SET, EXTRA LONG

- Extra long execution
- DIN ISO 2936
- Imperial sizes
- Continuous hardened
- Matt chrome
- Special tool steel
- In durable folding holder

10
pcs

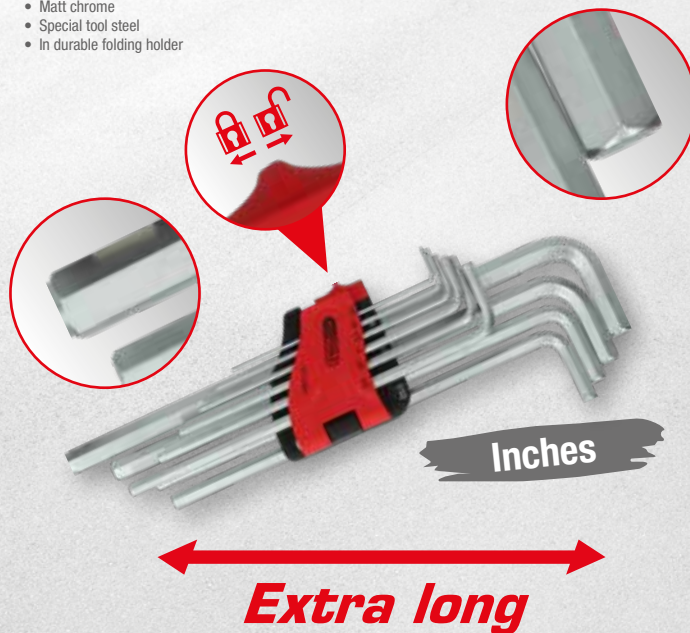
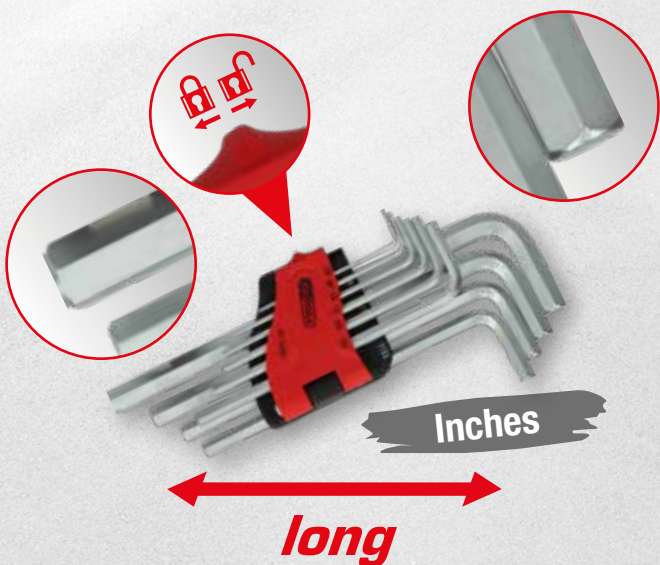

1/16" - 5/64" - 3/32" - 1/8" - 5/32" -
3/16" - 7/32" - 1/4" - 5/16" - 3/8"



1/16" - 5/64" - 3/32" - 1/8" - 5/32" -
3/16" - 7/32" - 1/4" - 5/16" - 3/8"

21,50 €

27,90 €

*This is an limited special price offer - only until stocks last.

All prices are ex. VAT. With the release of this leaflet all previous prices became invalid. Sold only in specialist stores. Print mistakes, errors and technical alterations excepted. Prices valid up to 30.09.2023



151.4640

ALLEN KEY SET, EXTRA LONG

- Extra long execution
- DIN ISO 2936
- each wrench width colour-coded
- Continuous hardened
- Matt chrome
- Special tool steel
- In durable folding holder

14
pcs

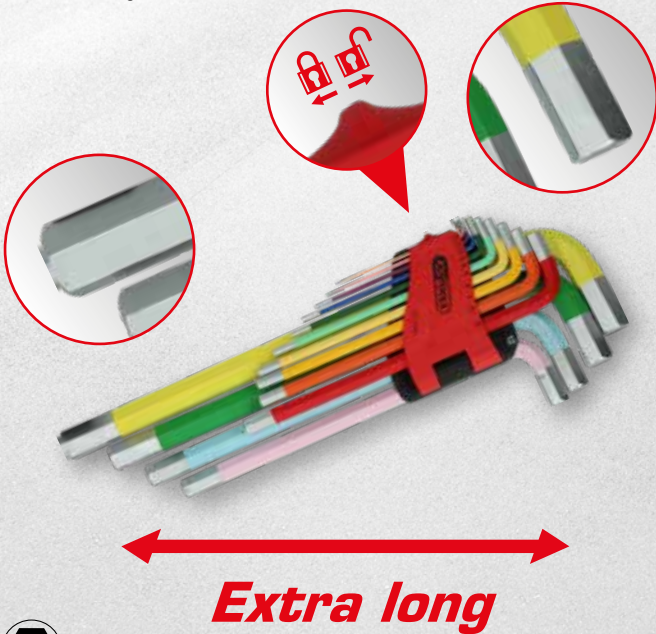

Extra long



1,5 - 2 - 2,5 - 3 - 4 - 5 - 6 - 7 -
8 - 10 - 12 - 14 - 17 - 19 mm

79,50 €

151.4650

ALLEN KEY SET, EXTRA LONG

- Extra long execution
- DIN ISO 2936
- Imperial sizes
- each wrench width colour-coded
- Continuous hardened
- Matt chrome
- Special tool steel
- In durable folding holder

14
pcs

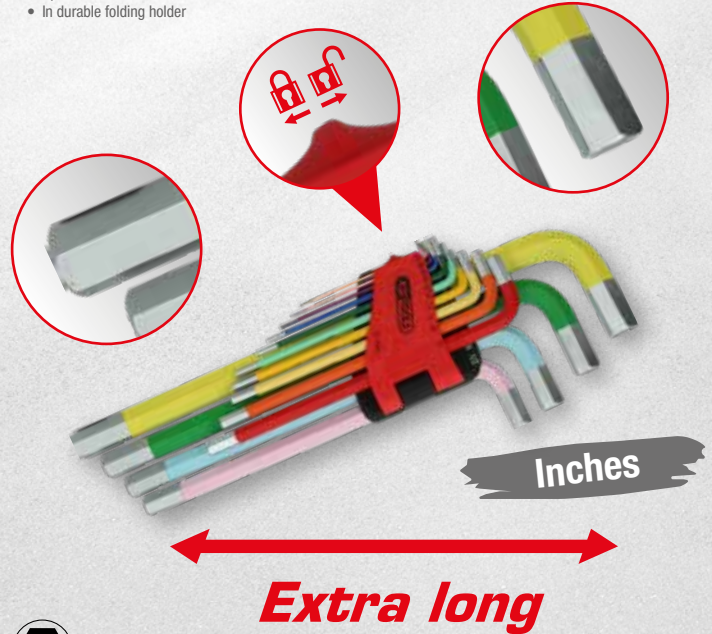

Inches

Extra long



1/16" - 5/64" - 3/32" - 1/8" - 5/32" - 3/16" - 7/32" -
1/4" - 5/16" - 3/8" - 1/2" - 9/16" - 5/8" - 3/4"

79,50 €

158.3520

BALL ENDED HEXAGON KEY WRENCH SET

- In accordance to DIN ISO 2936
- With ball end
- Ideal for difficult to access screws
- Continuous hardened
- Matt chrome
- Special tool steel
- In a durable folding holder with two component housing

8
pcs



2,5 - 3 - 4 - 5 - 6 - 7 - 8 - 10 mm

16,50 €

151.4780

BALLPOINT HEXAGON SOCKET WRENCH SET, SHORT

- Short execution
- DIN ISO 2936
- Ideal for difficult to access screws
- Continuous hardened
- Matt chrome
- Special tool steel
- In durable folding holder

10
pcs

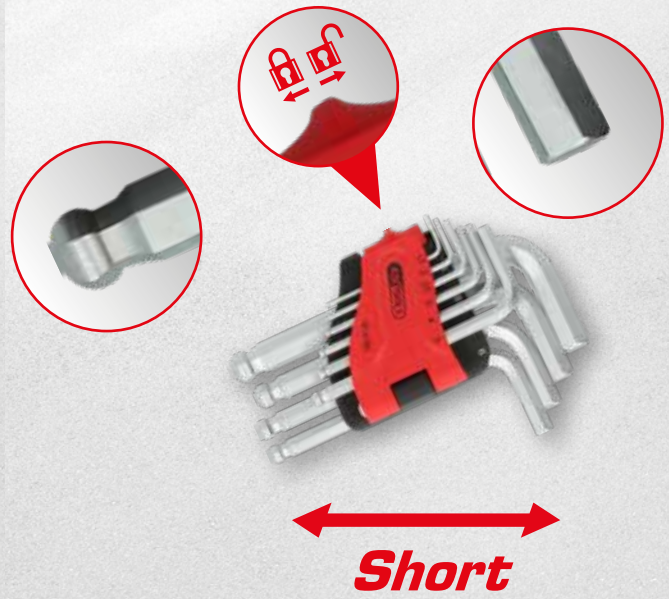

Short



1,5 - 2 - 2,5 - 3 - 4 - 5 - 6 - 7 - 8 - 10 mm

18,50 €



ALLEN KEY SETS

151.4740

BALLPOINT HEXAGON SOCKET WRENCH SET, SHORT

- Short execution
- DIN ISO 2936
- Imperial sizes
- Ideal for difficult to access screws
- Continuous hardened
- Matt chrome
- Special tool steel
- In durable folding holder

10
pcs

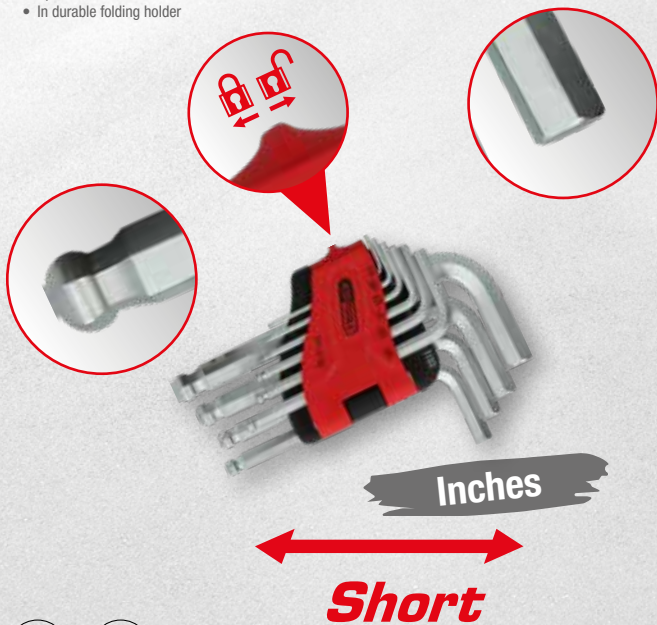

1/16" - 5/64" - 3/32" - 1/8" - 5/32" -
3/16" - 7/32" - 1/4" - 5/16" - 3/8"

18,50 €

151.5100

BALL END HEXAGON SOCKET WRENCH SET, LONG

- Long execution
- DIN ISO 2936
- Imperial sizes
- With ball head on the long end
- Ideal for difficult to access screws
- Continuous hardened
- Matt chrome
- Special tool steel
- In durable folding holder

10
pcs

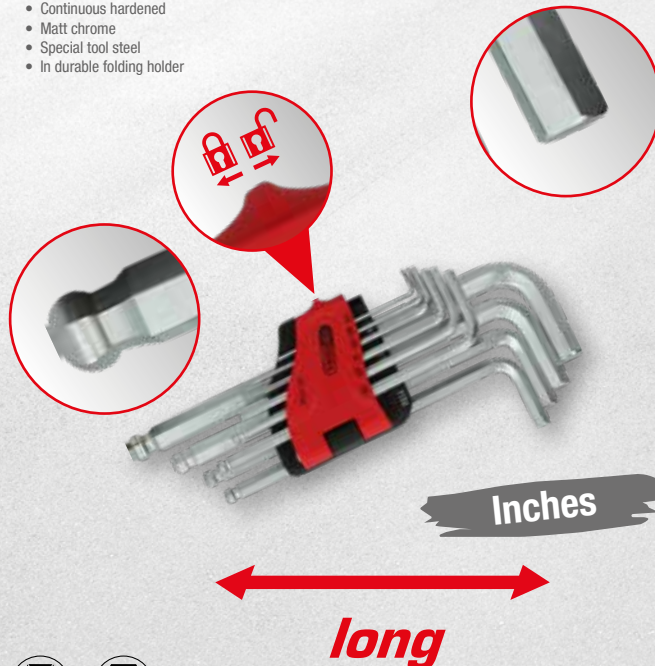

1/16" - 5/64" - 3/32" - 1/8" - 5/32" -
3/16" - 7/32" - 1/4" - 5/16" - 3/8"

27,90 €

151.5000

BALL END HEXAGON SOCKET WRENCH SET, LONG

- Long execution
- DIN ISO 2936
- With ball head on the long end
- Ideal for difficult to access screws
- Continuous hardened
- Matt chrome
- Special tool steel
- In durable folding holder

10
pcs

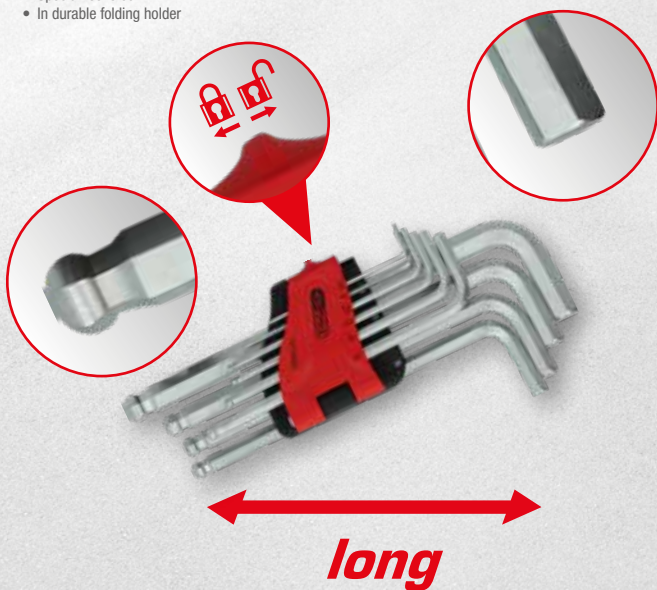

1,5 - 2 - 2,5 - 3 - 4 - 5 - 6 - 7 - 8 - 10 mm

18,50 €

151.4940

BALL END HEXAGON SOCKET WRENCH SET, EXTRA LONG

- Extra long execution
- DIN ISO 2936
- With ball head on the long end
- Ideal for difficult to access screws
- Continuous hardened
- Matt chrome
- Special tool steel
- In durable folding holder

10
pcs

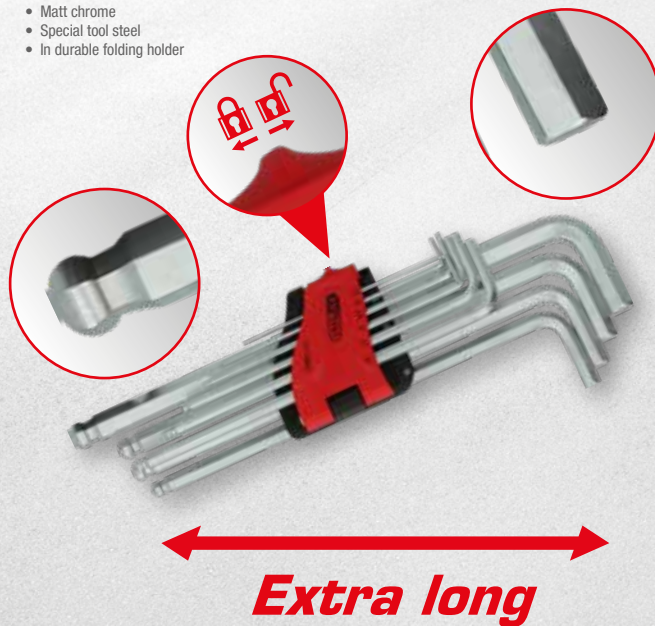

1,5 - 2 - 2,5 - 3 - 4 - 5 - 6 - 7 - 8 - 10 mm

27,90 €

*This is an limited special price offer - only until stocks last.

All prices are ex. VAT. With the release of this leaflet all previous prices became invalid. Sold only in specialist stores. Print mistakes, errors and technical alterations excepted. Prices valid up to 30.09.2023



151.2150

BALL END HEXAGON SOCKET WRENCH SET, EXTRA LONG

- Extra long execution
- DIN ISO 2936
- With ball head on the long end
- Ideal for difficult to access screws
- Continuous hardened
- Matt chrome
- Special tool steel
- In durable plastic storage case

10
pcs



3 - 4 - 5 - 6 - 7 - 8 - 10 - 12 - 14 - 17 mm

Extra long

46,50 €

151.4920

BALL END HEXAGON SOCKET WRENCH SET, EXTRA LONG

- Extra long execution
- DIN ISO 2936
- Imperial sizes
- With ball head on the long end
- Ideal for difficult to access screws
- Continuous hardened
- Matt chrome
- Special tool steel
- In durable folding holder

10
pcs

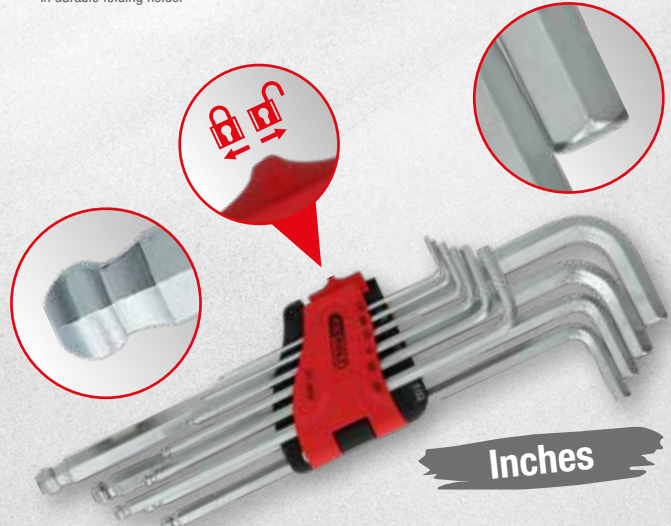

1/16" - 5/64" - 3/32" - 1/8" - 5/32" -
3/16" - 7/32" - 1/4" - 5/16" - 3/8"

Extra long

27,90 €

151.4420

BALL END HEXAGON SOCKET WRENCH SET, EXTRA LONG

- Extra long execution
- DIN ISO 2936
- With ball head on the long end
- Ideal for difficult to access screws
- each wrench width colour-coded
- Continuous hardened
- Matt chrome
- Special tool steel
- In durable folding holder

9
pcs

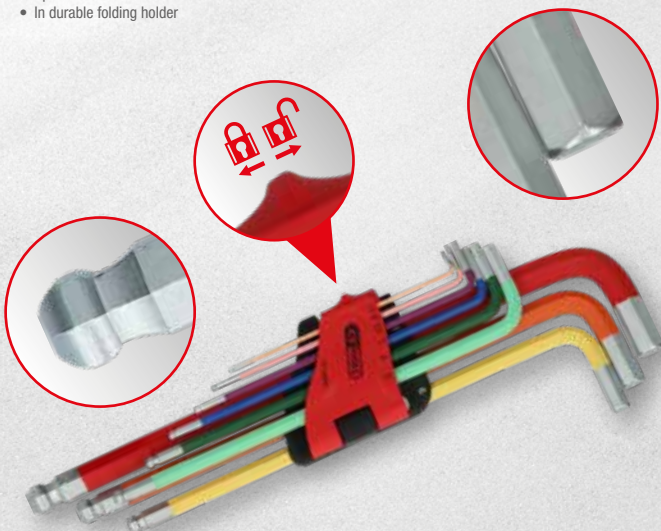

1,5 - 2 - 2,5 - 3 - 4 - 5 - 6 - 8 - 10 mm

Extra long

21,50 €

151.4520

BALL END HEXAGON SOCKET WRENCH SET, EXTRA LONG

- Extra long execution
- DIN ISO 2936
- Imperial sizes
- With ball head on the long end
- Ideal for difficult to access screws
- each wrench width colour-coded
- Continuous hardened
- Matt chrome
- Special tool steel
- In durable folding holder

9
pcs

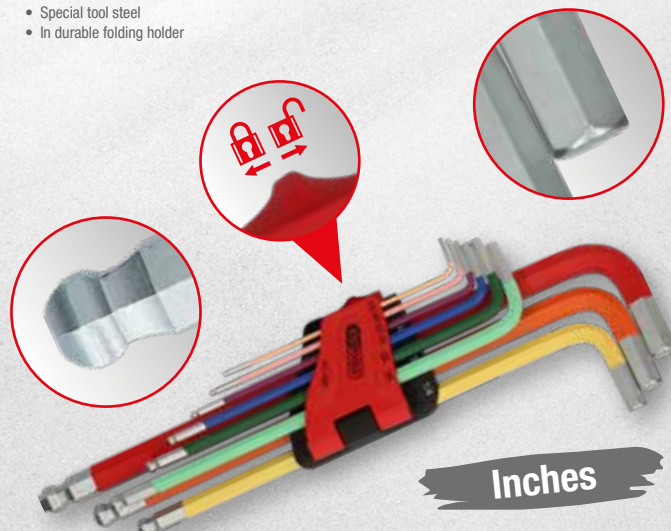

1/16" - 5/64" - 3/32" - 1/8" - 5/32" -
3/16" - 1/4" - 5/16" - 3/8"

Extra long

21,50 €



ALLEN KEY SETS

151.4560

BALL END HEXAGON SOCKET WRENCH SET, EXTRA LONG AND 108° ANGLED

- extra long version with 108° angled short side
- With ball head on the long end
- Ideal for difficult to access screws
- each wrench width colour-coded
- Continuous hardened
- Matt chrome
- In durable folding holder
- Special tool steel

9
pcs

151.4430

BALL END HEXAGON SOCKET WRENCH SET, EXTRA LONG AND 108° ANGLED

- extra long version with 108° angled short side
- Imperial sizes
- With ball head on the long end
- Ideal for difficult to access screws
- each wrench width colour-coded
- Continuous hardened
- Matt chrome
- Special tool steel
- In durable folding holder

9
pcs



1,5 - 2 - 2,5 - 3 - 4 - 5 - 6 - 8 - 10 mm

27,90 €



1/16" - 5/64" - 3/32" - 1/8" - 5/32" -
3/16" - 1/4" - 5/16" - 3/8"

Inches

Extra long

27,90 €

151.3222

DOUBLE BALL END HEXAGON SOCKET WRENCH SET, EXTREMELY LONG

- extremely long version
- DIN ISO 2936
- with ball head on the long end and the short end
- Ideal for difficult to access screws
- each wrench width colour-coded
- Continuous hardened
- Matt chrome
- Special tool steel
- In durable folding holder

9
pcs

each wrench width colour-coded



1,5 - 2 - 2,5 - 3 - 4 - 5 - 6 - 8 - 10 mm

27,90 €

	1,5 mm - 1/16"		T8	
	2,0 mm - 5/64"		T10	
	2,5 mm - 3/32"		T15	
	3,0 mm - 1/8"		T20	
	4,0 mm - 5/32"		T25	
	5,0 mm - 3/16"		T27	
	6,0 mm - 7/32"		T30	
	7,0 mm - 1/4"		T40	
	8,0 mm - 5/16"		T45	
	10,0 mm - 3/8"		T50	
	12,0 mm - 1/2"		T55	
	14,0 mm - 9/16"		T60	
	17,0 mm - 5/8"		T70	
	19,0 mm - 3/4"		T80	

*This is an limited special price offer - only until stocks last.

All prices are ex. VAT. With the release of this leaflet all previous prices became invalid. Sold only in specialist stores. Print mistakes, errors and technical alterations excepted. Prices valid up to 30.09.2023

158.3510

TORX KEY WRENCH SET

- Continuous hardened
- Matt chrome
- Special tool steel
- In a durable folding holder with two component housing



T8 - T10 - T15 - T20 - T25 - T27 - T30 - T40

11,90 €

8 pcs

151.4880

TORX L-KEY SET, LONG

- Long execution
- Continuous hardened
- Matt chrome
- Special tool steel
- In durable folding holder

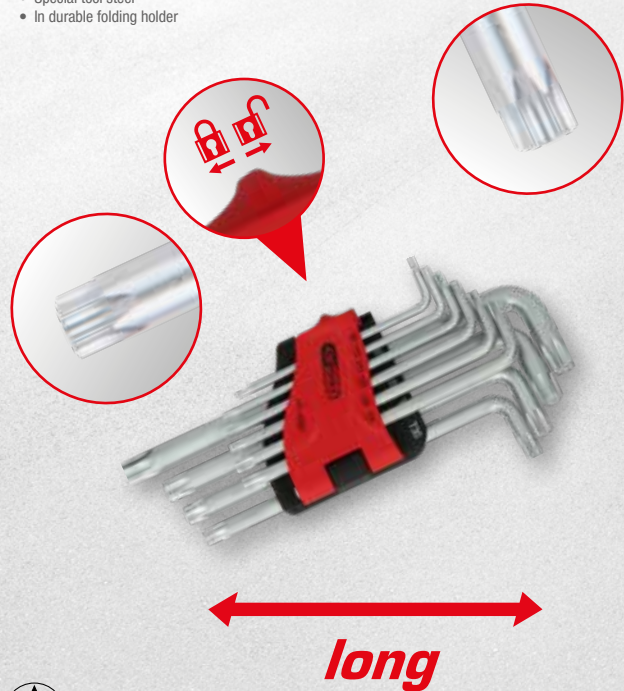

T8 - T10 - T15 - T20 - T25 - T27 - T30 - T40 - T45 - T50

18,50 €

10 pcs

TORX ANGLE KEY WRENCH SET, SHORT

- Short execution
- Continuous hardened
- Matt chrome
- Special tool steel
- In durable folding holder

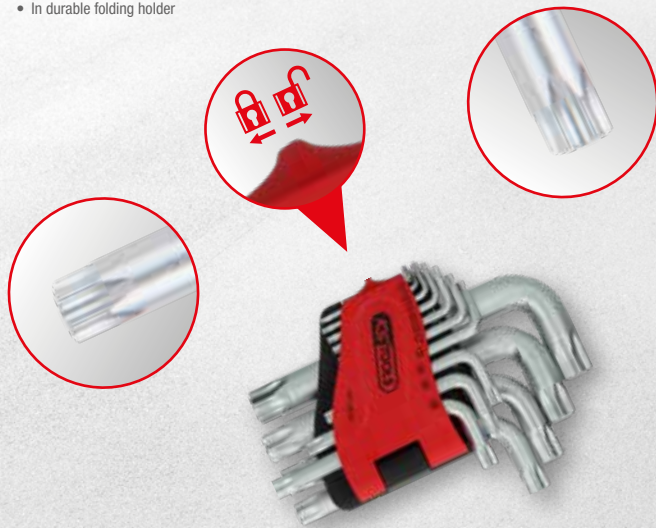

Short

TORX L-KEY SET, EXTRA LONG

- Extra long execution
- Continuous hardened
- Matt chrome
- Special tool steel
- In durable folding holder

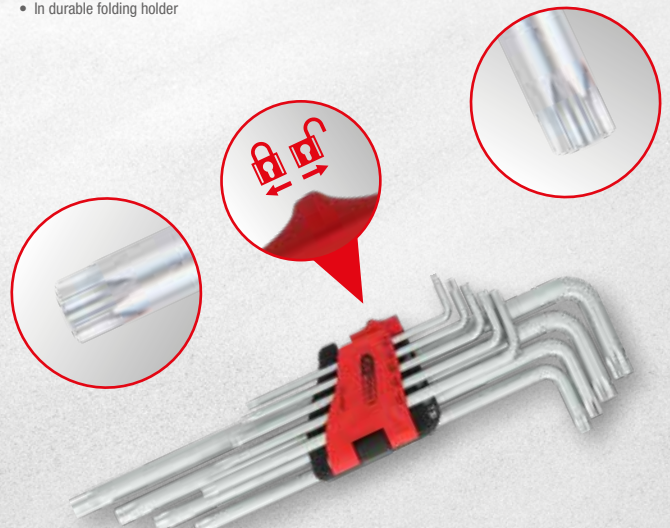

Extra long

151.4900	10 pcs	T10 - T15 - T20 - T25 - T27 - T30 - T40 - T45 - T50	€ 21,50
151.4610	14 pcs	T8 - T10 - T15 - T20 - T25 - T27 - T30 - T40 - T45 - T50 - T55 - T60 - T70 - T80	€ 54,50

151.4550	9 pcs	T10 - T15 - T20 - T25 - T27 - T30 - T40 - T45 - T50	€ 27,90
151.4860	10 pcs	T8 - T10 - T15 - T20 - T25 - T27 - T30 - T40 - T45 - T50	€ 27,90



TORX L-KEY SET, EXTRA LONG

- Extra long execution
- each wrench width colour-coded
- Continuous hardened
- Matt chrome
- In durable folding holder
- Special tool steel



151.4760	9 pcs	T10 - T15 - T20 - T25 - T27 - T30 - T40 - T45 - T50	€ 27, ⁹⁰
151.4440	14 pcs	T8 - T10 - T15 - T20 - T25 - T27 - T30 - T40 - T45 - T50 - T55 - T60 - T70 - T80	€ 90, ⁹⁰

151.5210

BALL HEAD TORX ANGLED SOCKET WRENCH SET, EXTRA LONG

- Extra long execution
- With ball head on the long end
- each wrench width colour-coded
- Continuous hardened
- Matt chrome
- Special tool steel
- In durable folding holder

9 pcs



T10 - T15 - T20 - T25 - T27 - T30 - T40 - T45 - T50

39,⁵⁰ €

151.5180

BALL HEAD TORX ANGLED SOCKET WRENCH SET, LONG

- Long execution
- With ball head on the long end
- Continuous hardened
- Matt chrome
- Special tool steel
- In durable folding holder

10 pcs

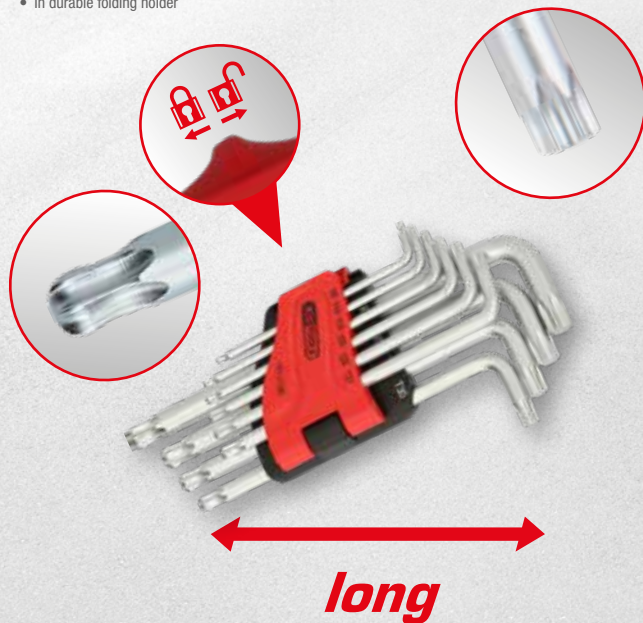

T8 - T10 - T15 - T20 - T25 - T27 - T30 - T40 - T45 - T50

34,⁵⁰ €

151.4530

BALL HEAD TORX ANGLED SOCKET WRENCH SET, EXTRA LONG AND 108° ANGLED

- extra long version with 108° angled short side
- With ball head on the long end
- Ideal for difficult to access screws
- each wrench width colour-coded
- Continuous hardened
- Matt chrome
- Special tool steel
- In durable folding holder

9 pcs



T10 - T15 - T20 - T25 - T27 - T30 - T40 - T45 - T50

34,⁵⁰ €

*This is an limited special price offer - only until stocks last.

All prices are ex. VAT. With the release of this leaflet all previous prices became invalid. Sold only in specialist stores. Print mistakes, errors and technical alterations excepted. Prices valid up to 30.09.2023



158.3530

TORX TAMPERPROOF KEY WRENCH SET

- Tamperproof
- Continuous hardened
- Matt chrome
- Special tool steel
- In a durable folding holder with two component housing



TB8 - TB10 - TB15 - TB20 - TB25 - TB27 - TB30 - TB40

16,50 €

8 pcs

151.4840

TORX RIGHT-ANGLE WRENCH SET WITH BORE, SHORT

- Short execution
- Bore hole at the short and long end
- Continuous hardened
- Matt chrome
- Special tool steel
- In durable folding holder

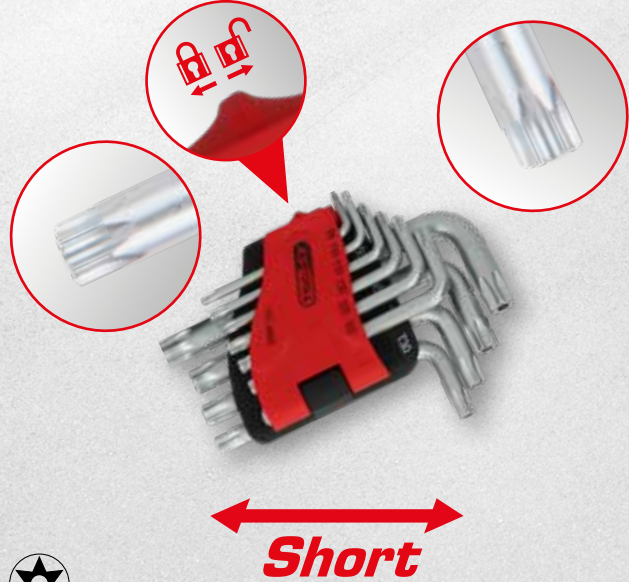

TB8 - TB10 - TB15 - TB20 - TB25 - TB27 - TB30 - TB40 - TB45 - TB50

21,50 €

10 pcs

151.4570

TORX RIGHT-ANGLE WRENCH SET WITH BORE, SHORT

- Short execution
- Bore hole at the short and long end
- Continuous hardened
- Matt chrome
- Special tool steel
- In durable folding holder

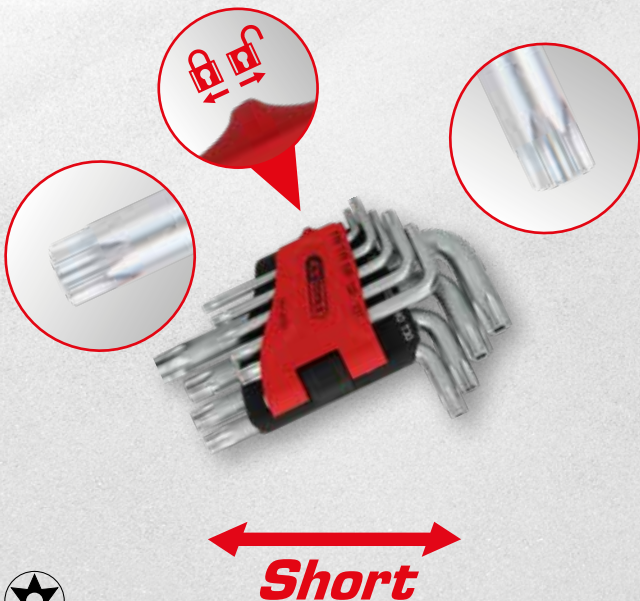

TB10 - TB15 - TB20 - TB25 - TB27 - TB30 - TB40 - TB45 - TB50

18,50 €

9 pcs

151.4820

TORX RIGHT-ANGLE WRENCH SET WITH BORE, LONG

- Long execution
- Bore hole at the short and long end
- Continuous hardened
- Matt chrome
- Special tool steel
- In durable folding holder

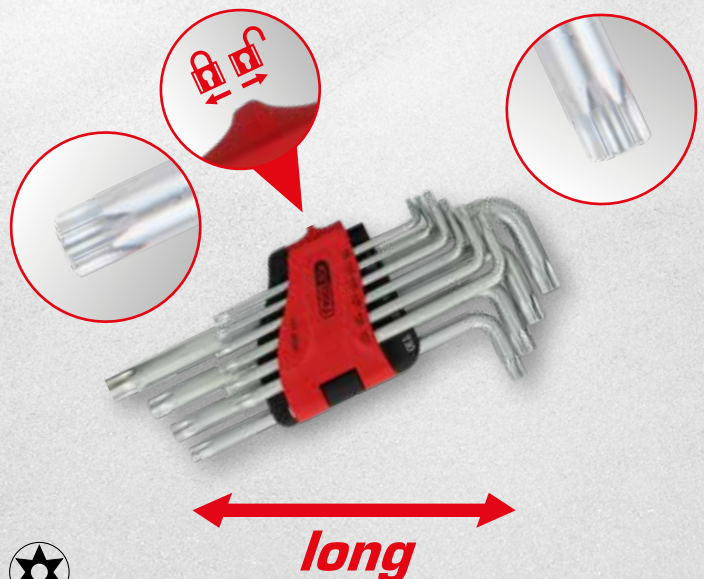

TB8 - TB10 - TB15 - TB20 - TB25 - TB27 - TB30 - TB40 - TB45 - TB50

27,90 €

10 pcs



ALLEN KEY SETS



151.4580

TORX RIGHT-ANGLE WRENCH SET WITH BORE, EXTRA LONG

- Extra long execution
- Bore hole at the short and long end
- Continuous hardened
- Matt chrome
- Special tool steel
- In durable folding holder

9 pcs

151.2482

FIVE STAR PROFILE TAMPERPROOF KEY WRENCH SET

- Long execution
- Bore hole at the short and long end
- Continuous hardened
- Matt chrome
- Special tool steel
- In durable folding holder

10 pcs

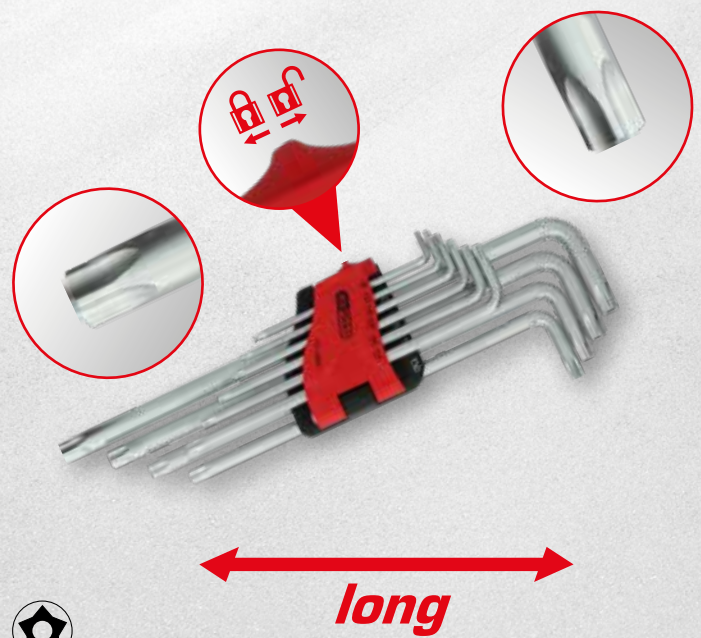
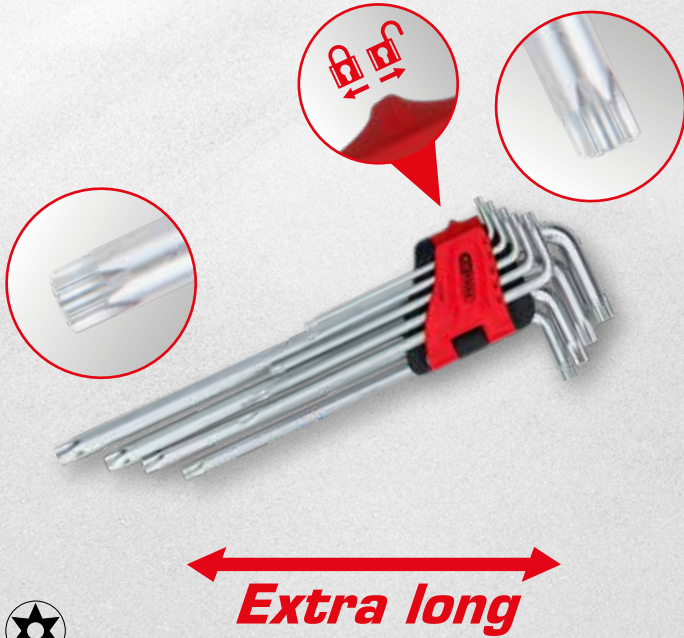

TB10 - TB15 - TB20 - TB25 - TB27 - TB30 - TB40 - TB45 - TB50

27,90 €



TS8 - TS10 - TS15 - TS20 - TS25 - TS27 - TS30 - TS40 - TS45 - TS50

34,50 €

151.4800

TORX RIGHT-ANGLE WRENCH SET WITH BORE, EXTRA LONG

- Extra long execution
- Bore hole at the short and long end
- Continuous hardened
- Matt chrome
- Special tool steel
- In durable folding holder

10 pcs



TB8 - TB10 - TB15 - TB20 - TB25 - TB27 - TB30 - TB40 - TB45 - TB50

34,50 €



*This is an limited special price offer - only until stocks last.

All prices are ex. VAT. With the release of this leaflet all previous prices became invalid. Sold only in specialist stores. Print mistakes, errors and technical alterations excepted. Prices valid up to 30.09.2023



151.4620

RIBE® KEY WRENCH SET, SHORT

- Short execution
- Continuous hardened
- Matt chrome
- Special tool steel
- In durable folding holder

9
pcs

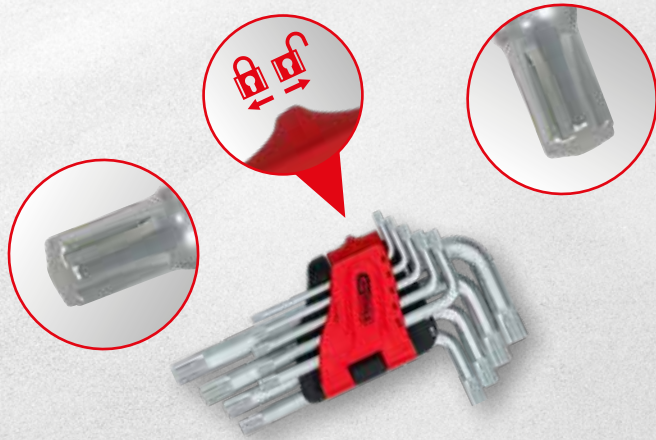

Short



M4 - M5 - M6 - M8 - M10 - M12 - M14 - M16 - M18

54,50 €

151.4100

SPLINE KEY WRENCH SET

- Short execution
- Continuous hardened
- Matt chrome
- Special tool steel
- In sturdy sheet steel box

5
pcs

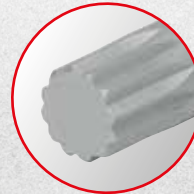
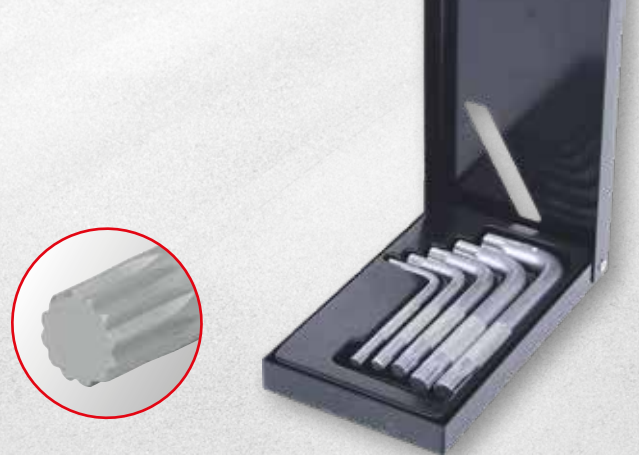

Short



M5 - M6 - M8 - M10 - M12

18,50 €

151.4500

RIBE®-ANGLE L-KEY SET, EXTRA LONG

- Extra long execution
- each wrench width colour-coded
- Continuous hardened
- Matt chrome
- Special tool steel
- In durable folding holder

9
pcs

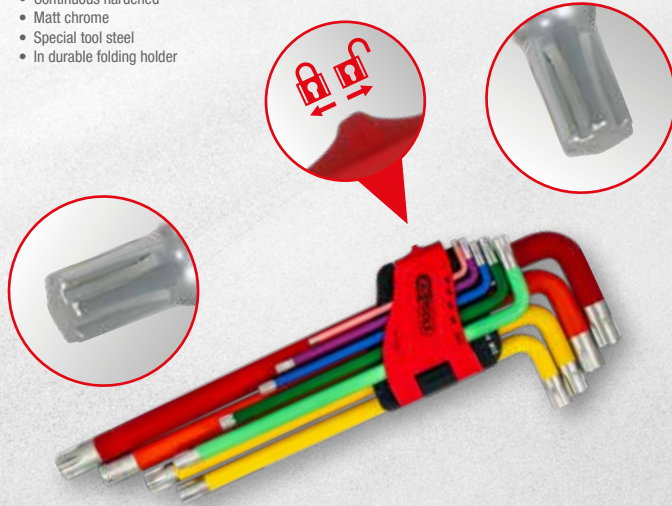

Extra long



M4 - M5 - M6 - M8 - M10 - M12 - M14 - M16 - M18

79,50 €

151.4630

SPLINE KEY WRENCH SETSHORT

- Short execution
- Continuous hardened
- Matt chrome
- Special tool steel
- In durable folding holder

9
pcs

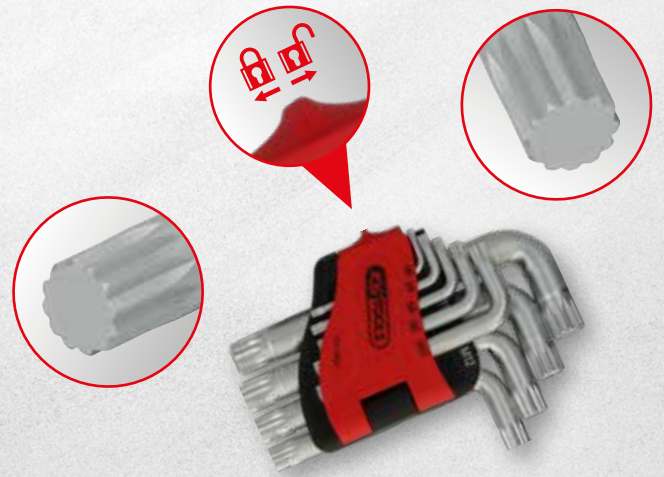

Short



M4 - M5 - M6 - M8 - M10 - M12 - M14 - M16 - M18

46,50 €



ALLEN KEY SETS

151.4510

SPLINE KEY WRENCH SET, EXTRA LONG

- Extra long execution
- each wrench width colour-coded
- Continuous hardened
- Matt chrome
- Special tool steel
- In durable folding holder

9
pcs

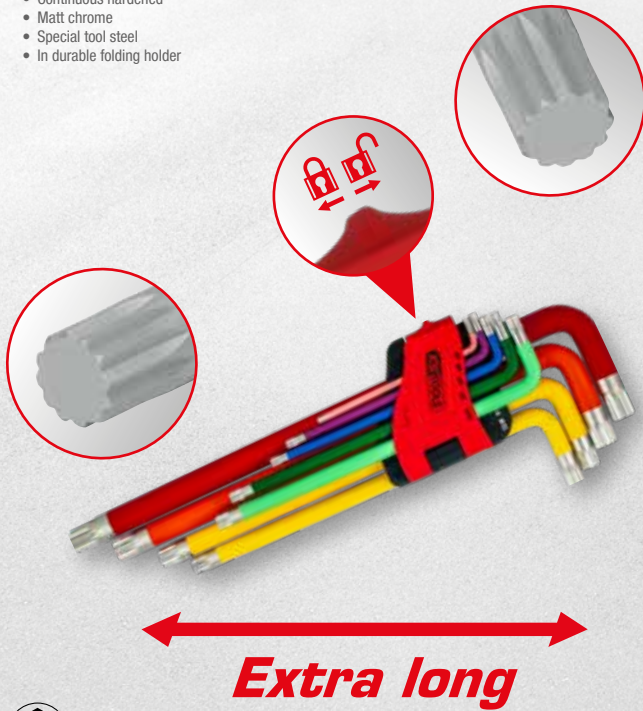

M4 - M5 - M6 - M8 - M10 - M12 - M14 - M16 - M18

79,50 €

158.8130

T-HANDLE KEY WRENCH SET

- In accordance to DIN ISO 2936
- Two component handle
- Continuous hardened
- Matt chrome
- Special tool steel
- In durable wall holder

8
pcs



2 - 2,5 - 3 - 4 - 5 - 6 - 8 - 10 mm

52,50 €

158.5000

T-HANDLE SOCKET SREWDRIWER SET

- FlankTraction profile
- Two component handle
- Continuous hardened
- Matt chrome
- Special tool steel
- In sturdy wall bracket

6
pcs

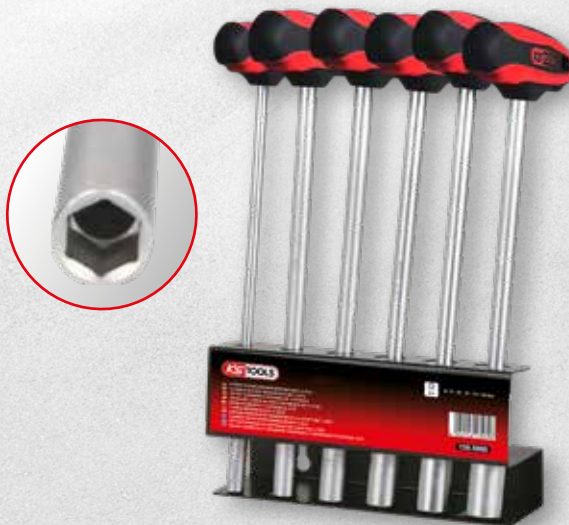

6 - 8 - 10 - 12 - 13 - 14 mm

52,50 €

158.5100

3 WAY T-HANDLE HEXAGONAL KEY WRENCH SET

- Hexagonal profile on three ends
- For difficult to access areas
- Matt finish
- Chrome finish with burnished tips
- Chrome vanadium
- In durable plastic storage case

8
pcs



2 - 2,5 - 3 - 4 - 5 - 6 - 8 - 10 mm

90,90 €

151.8155

T-HANDLE BALL ENDED HEXAGON KEY WRENCH SET

- With ball head on the long end
- Ideal for difficult to access screws
- Two component handle
- Continuous hardened
- Matt chrome
- Special tool steel



2 - 2,5 - 3 - 4 - 5 - 6 - 8 - 10 mm

46,50 €

8 pcs

158.8160

T-HANDLE TORX KEY WRENCH SET

- Two component handle
- Continuous hardened
- Matt chrome
- Special tool steel
- In durable wall holder



T10 - T15 - T20 - T25 - T27 - T30 - T40 - T45 - T50

60,90 €

9 pcs

151.8150

T-HANDLE BALL ENDED HEXAGON KEY WRENCH SET

- With ball head on the long end
- Ideal for difficult to access screws
- Two component handle
- Continuous hardened
- Matt chrome
- Special tool steel
- In durable plastic storage case



2 - 2,5 - 3 - 4 - 5 - 6 - 8 - 10 - 12 mm

48,50 €

9 pcs

158.8050

T-HANDLE TORX KEY WRENCH SET

- Extra long execution
- Two component handle
- Continuous hardened
- Matt chrome
- Special tool steel

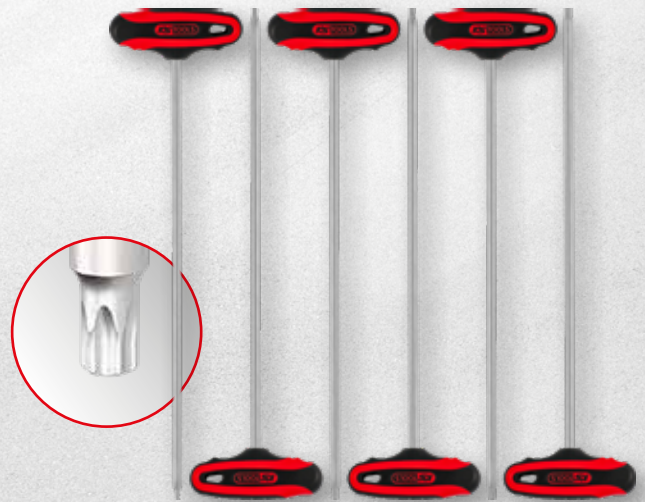

T10 - T15 - T20 - T25 - T27 - T30

Extra long

79,50 €

6 pcs



158.5200

3 WAY T-HANDLE TORX KEY WRENCH SET

- Torx profile on three ends
- For difficult to access areas
- Matt finish
- Chrome finish with burnished tips
- Chrome vanadium
- In durable plastic storage case

9
pcs



T10 - T15 - T20 - T25 - T27 -
T30 - T40 - T45 - T50

106,⁹⁰ €

151.8165

T-HANDLE TORX TAMPERPROOF KEY WRENCH SET

- Tamperproof
- Two component handle
- Continuous hardened
- Matt chrome
- Special tool steel

8
pcs

151.8160

T-HANDLE TORX TAMPERPROOF KEY WRENCH SET

- Tamperproof
- Two component handle
- Continuous hardened
- Matt chrome
- Special tool steel
- In durable plastic storage case

9
pcs



TB9 - TB10 - TB15 - TB20 - TB25 - TB27 -
TB30 - TB40



TB10 - TB15 - TB20 - TB25 - TB27 -
TB30 - TB40 - TB45 - TB50

46,⁵⁰ €

48,⁵⁰ €



PREMIUM-WERKZEUGE



PREMIUM TOOLS



Your Local Distributor

PREMIUM-WERKZEUGE



PREMIUM TOOLS

KS Tools Werkzeuge - Maschinen GmbH

Seligenstädter Grund 10 - 12
D-63150 Heusenstamm

 GERMANY

Tel.: +49(0) 61 04 49 74-0

Fax: +49(0) 61 04 49 74-11

e-mail: kstools@kstools.de

www.kstools.com



LL22-29EN_EUR

*This is an limited special price offer - only until stocks last.

All prices are ex. VAT. With the release of this leaflet all previous prices became invalid. Sold only in specialist stores. Print mistakes, errors and technical alterations excepted. Prices valid up to 30.09.2023